

Mortice locks

Overview	533
Mortice locks acc. to DIN 18 251-1 Class 5	534
Mortice locks acc. to DIN 18 251-1 Class 3	536
Mortice locks for framed doors acc. to DIN 18 251-2 Class 3	538
Strike plates	539
Euro profile cylinders	540

Mortice locks by FSB

Satisfactory doesn't satisfy us

Competent product solutions ought to be a matter of course for a highly evolved society, as should equally reliable functioning over a product's full life cycle. Doors accompany our lives for a great many years after all. That's reason enough to scrutinise the material, design, engineering but also, crucially, the durability of a door in its entirety. Durability equates with cost-effectiveness, meaning that dearer can be cheaper in the long run. That's because, as well as procurement costs, it is also necessary to bear in mind all outgoings over a product's anticipated life cycle – repairs, servicing and any replacement included. That holds particularly true for doors subject to constant heavy-duty operation – open/shut, open/shut, open/shut – for many decades.

It's accordingly a question of the stability of the door in its entirety. And that ultimately depends on the performance properties of all the individual components, those being:

- lock
- hardware
- cylinder
- hinges
- frame
- door leaf

A system's overall performance, however, is as strong as its weakest link, as they say. It is not enough, therefore, to conform to standards that solely relate to individual components.

Locks by FSB: Quality "Made in Germany"

In its capacity as an international project brand and in keeping with the approach it has to quality in any case, FSB is therefore adding Class 3 and 5 mortise locks and Class 3 panel locks to its product range with publication of the present Manual, specifically with a view to providing its international market partners co-ordinated entire solution from a single source.

Quality requirements laid down by EN 12 209

European standard EN 12 209 governs the requirements and test methods for locks. The DIN 18 251-1 and 18 250 standards, which are made up within EN 12 209, divide quality requirements into five use-related Classes as adumbrated below:

Class 1:
Locks for lightweight doors

Class 2:
Locks for internal doors

Class 3:
Cylinder locks for flat-entrance and heavy-duty doors, cf. pages 536f.

Class 4:
Cylinder locks for heavily-used doors (+ anti-burglary devices)

Class 5:
Cylinder locks for very heavily-used doors (+ anti-burglary devices), cf. pages 534f.

In practical planning terms the lock class selected reflects the door's anticipated level of use. Where there is any uncertainty regarding the level of use of doors in building projects, FSB recommends erring on the side of safety by opting for FSB Class 5 heavy-duty locks.

Our cooperation partner SSF, which has been making locks for over a century, has developed a new series of locks that are suitable for heavily-used doors in every respect. Setting them apart are superlative workmanship, manufacturing accuracy and their modular configuration. The provisions of DIN 18 51-1 for a "Class 5" rating are met and, indeed, exceeded. For detailed information on this lock please turn to pages 534f.

Mortice locks for framed doors

In the case of hardware for framed doors in particular, though, reliable functioning is dependent not only on the lever handle and its bearings but also on the fixing system. FSB has thus optionally adapted the fixing system for its framed door hardware to FSB 02 Series/Class 3 framed door locks with through fixing points. A special fixing set enables FSB framed door hardware to be prepared to order at the works. As well as ensuring a secure fit, this form of through fixing also makes for significantly shorter assembly times for framed door hardware.

The requisite panel locks are to be found on page 538, the attendant fixing set on page 551.

The package is completed by strike plates and Euro profile cylinders by German manufacturer Winkhaus.

Overview

● New products 09110



8813 0006 ●
Page 534



8813 0001 ●
Page 536



8813 0002 ●
Page 537



8813 0003 ●
Page 537



8813 0004 ●
Page 537



8813 0007 ●
Page 538

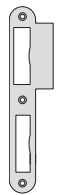

8814 0001|02 ●
Page 539



8812 2001|02 ●
Page 540



8812 2101|02 ●
Page 541



8812 2201|02 ●
Page 540

Mortice locks acc. to DIN 18 251-1 Class 5

Features:

1. Latchbolt steel nickel plated with sound damping function
2. Gripping steel follower
3. Follower with steel bearing
4. Hardened steel deadbolt with conical design
5. Protective sleeve at all through fixing points
6. High quality sprung follower for durability and preventing handle sagging
7. Auxiliary anti thrust bolt, supplied on request
8. Latchbolt reversible without opening lockcase, deadbolt design symmetric, latchbolt and deadbolt in the center
9. Fully enclosed lock case, zinc plated and lacquered
10. Lubrication device
11. Corrosion safety class 4, acc. to German DIN standard 1670 (240 hrs. salt spray test)
12. Screw guide for cylinder fixing
13. Backsets from 50 mm up to 100 mm
14. Tested and certified for fire and smoke stop doors acc. to German DIN standard 18 250 with 9 mm □ follower, 10 mm □ follower also supplied on request
15. Stainless steel forend, material no. 4301

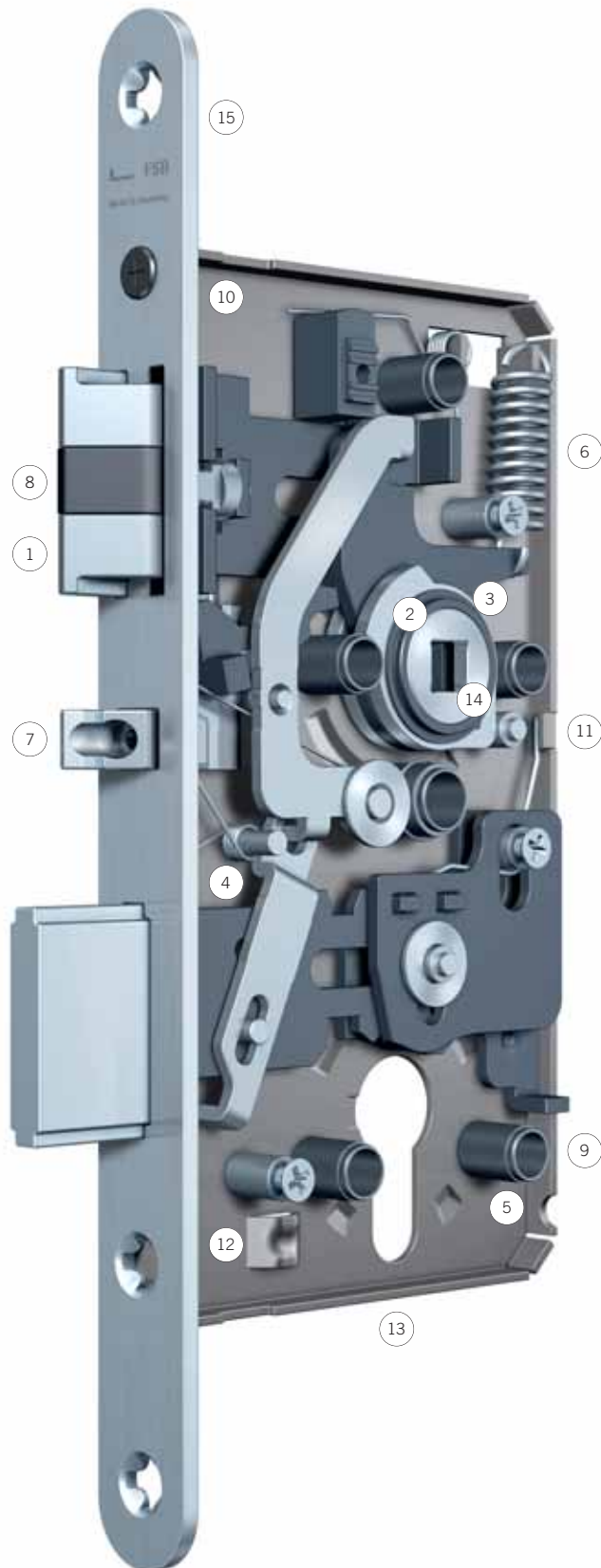

Mortice locks acc. to DIN 18 251-1 Class 5



8813 0006

Mortice lock acc. to German DIN 18 251-1, Class 5

Reversible latch
Euro profile cylinder cut out (PZ) 72 mm
Latchbolt can be retracted by cylinder

Latchbolt reversible without opening lockcase
Latchbolt and deadbolt centered on forend
Deadbolt double-throw: 20 mm
Spindle: 8 mm □
Spacing: 72 mm
Backset: 55 mm
Forend width: 24 mm, Stainless steel, rounded

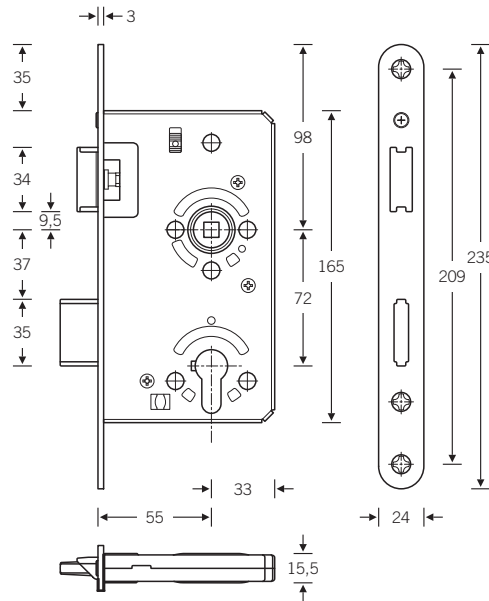

Versions supplied on request:

- Backsets 50, 60, 65, 80 and 100 mm
- Follower with 9 or 10 mm □
- Square forend
- Forend width 20 mm
- Forend in different materials (brass) and finishes
- WC/bathroom version (cf. illustration beside)

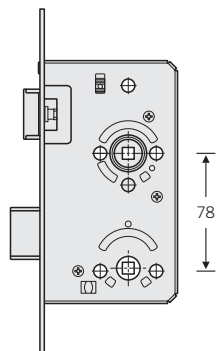

Equipment:

- All versions with through fixing point for FSB roses 1731/1735 + 1707/1708
- Supplied with 2 pcs. screws Phillips drive 4.5 x 25 mm

Mortice locks acc. to DIN 18 251-1 Class 3



8813 0001

Mortice lock acc. to German
DIN 18 251-1, Class 3

Latchbolt can be retracted by
cylinder

Euro profile cylinder cut out
(PZ), spacing 72 mm

Latchbolt reversible without
opening lockcase
Latchbolt and deadbolt centered
on forend
Deadbolt double-throw: 20 mm
Spindle: 8 mm □
Spacing: 72 mm
Backset: 55 mm
Forend width: 24 mm, Stain-
less steel, rounded

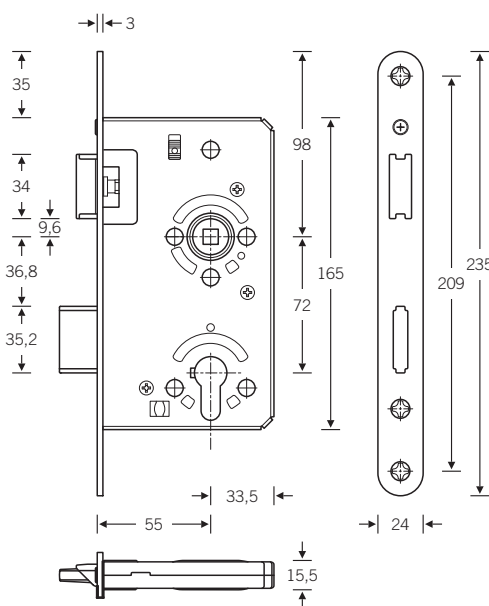

Versions supplied on request:

- Backsets 50, 60, 65, 80 and 100 mm
- Follower with 9 or 10 mm □
- Square forend
- Forend width 20 mm
- Forend in different materials (brass) and finishes

Features:

- Gripping steel follower with nylon bearing
- High quality sprung follower for durability and preventing handle sagging
- Latchbolt steel nickel plated
- Conical steel dead bolt
- Fully enclosed lock case, zinc plated
- Lubrication device
- Chip covering sleeve at follower through fixing points
- All versions with through fixing point for FSB roses 1731/1735 + 1707/1708
- Supplied with 2 pcs. screws Phillips drive 4.5 x 25 mm

Mortice locks acc. to DIN 18 251-1 Class 3

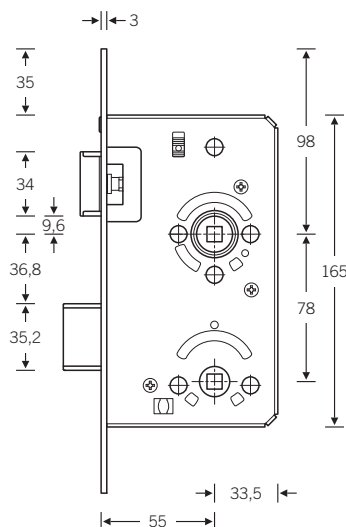

8813 0002

Mortice lock acc. to German DIN 18 251-1, Class 3

Bathroom/WC function

Latchbolt reversible without opening lockcase
 Latchbolt and deadbolt centered on forend
 Deadbolt double-throw: 20 mm
 Gripping follower: 8 mm
 Spacing: 78 mm
 Indic. furniture follower: 8 mm

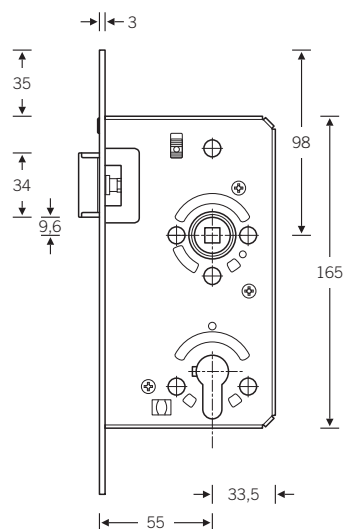

8813 0003

Mortice lock acc. to German DIN 18 251-1, Class 3

Latch function

Latchbolt reversible without opening lockcase
 Latchbolt centered on forend
 Gripping follower 8 mm

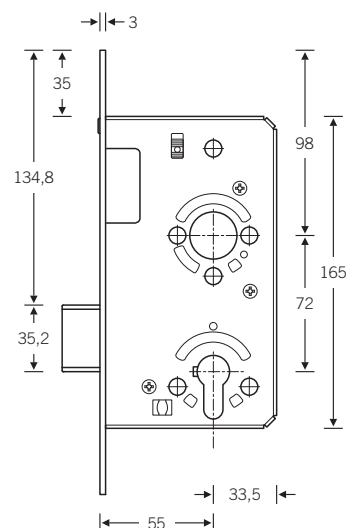

8813 0004

Mortice lock acc. to German DIN 18 251-1, Class 3

Deadbolt function, double-throw 20 mm

Deadbolt in the center

9a

Mortice locks for framed doors acc. to DIN 18 251-2 Class 3



8813 0007

Mortice lock for framed doors
acc. to German DIN 18 251-1,
Class 3

Euro profile cylinder cut out
(PZ), spacing 92 mm

Latchbolt reversible without
opening lockcase
Latchbolt and deadbolt centered
on forend
Deadbolt single-throw: 21 mm
Follower: 8 mm
Backset: 35 mm
Forend width: 24 mm, Stain-
less steel, square

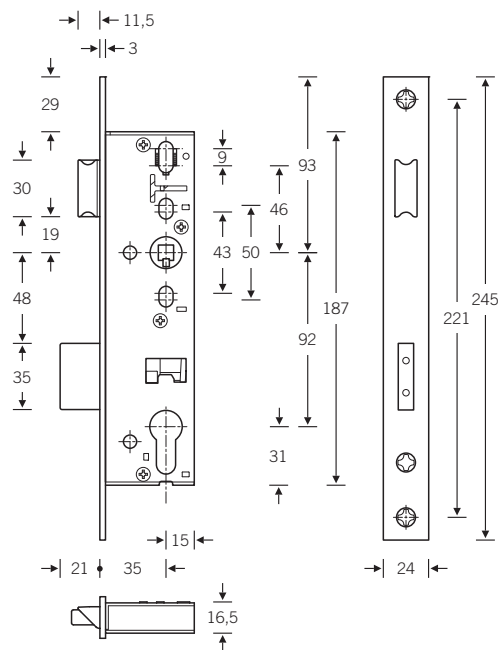

Versions supplied on request:

- Backsets 25, 30, 40, 45, and 50 mm
- Forend widths 16, 20, 22 and 25 mm
- Forend in different finishes
- Follower with 10 mm □
- Latchbolt and deadlock with projection 5 mm (backsets equal or smaller than 45 mm)

Features:

- Latchbolt with sound damping function
- Latchbolt and deadbolt nickel plated
- Gripping steel follower
- Lock case closed on top and on bottom
- Chip covering sleeve at follower through fixing points

Strike plates

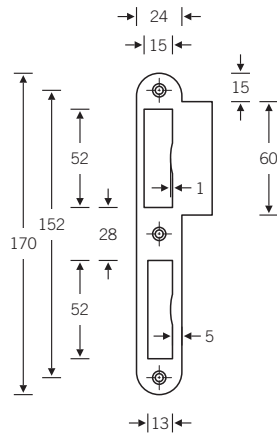
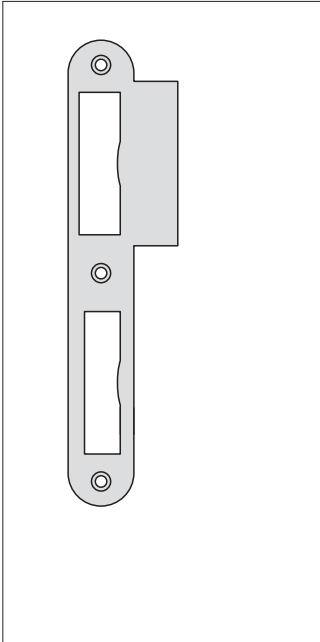

Illustration : l.h.

8814 0001

l.h.

8814 0002

r.h.

■ Stainless steel

Thickness 2 mm

Supplied with 3 pcs. screws
Phillips drive 3.5 x 20 mm

Different finishes available on
request

Euro profile cylinders

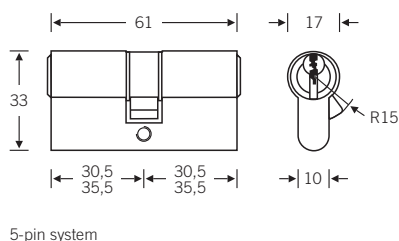

8812 2001

30.5 / 30.5 mm

8812 2002

35.5 / 35.5 mm

Euro profile double-cylinder
Type 01

Areas of application:
– Inside and outside
– Standard doors

Properties:
– Reinforced key guide via
special cylinder cores
– Sintered steel cylinder cam

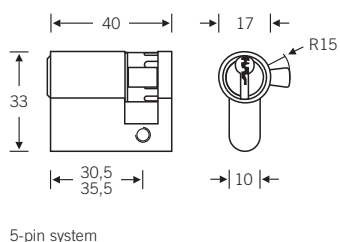

8812 2201

30.5 mm

8812 2202

35.5 mm

Euro profile half-cylinder
Type 02

Areas of application:
– Mortice locks
– Garage door locks
– Key switch

Properties:
– Easily adjustable cylinder
cam
– Reinforced key guide via
special
– Sintered steel cylinder cam

Note:

Not suitable for use in anti-panic multiple locking devices.



– Supplied with 3 pcs. metal
keys
– Labeled with “Winkhaus”
and “FSB” each one side

Euro profile cylinder

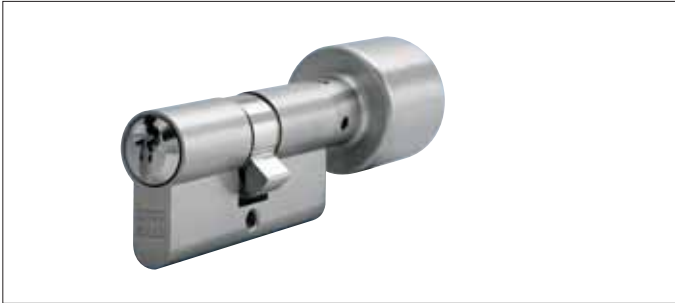

8812 2101

30.5 / 30.5 mm

8812 2102

35.5 / 35.5 mm

Euro profile thumbturn
cylinder
Type 04

Areas of application:

- Indoors
- Front doors

Properties:

- Outside: locking cylinder,
inside: thumbturn
- Reinforced key guide via
special cylinder cores
- Sintered steel cylinder cam

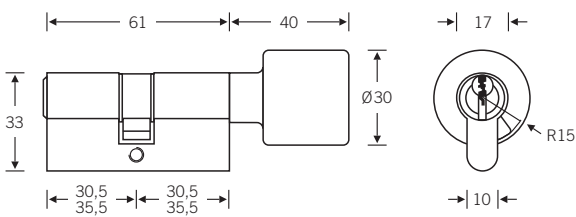

5-pin system

Note:

Not suitable for use in anti-panic multiple locking devices.

Functionally, keys can be turned empty up to 355°.



- Supplied with 3 pcs. metal keys
- Labeled with "Winkhaus" and "FSB" each one side

9a

